



Doing it Right!

BEETEC[®]



UP TO 120" AND 136.4kg
MOTORIZED LIFT

FITS 75"-120"

Motorized Height Adjustable
Heavy Duty Mobile Cart

INSTRUCTION

Motorized Versatile Professional Mobile Cart for Extra Large Screen
Education and Video Conference Room Solution



تك فورت للتجارة العامة ش م م

TECHFORT

MOTORIZED VERSATILE PROFESSIONAL MOBILE CART FOR EXTRA LARGE SCREEN EDUCATION AND VIDEO CONFERENCE ROOM SOLUTION



This is a versatile monitor stand designed for large screens ranging from 75 to 120 inches. It supports a maximum load of 300 lbs (136.4 kg) and is compatible with VESA mounting patterns from 200x200mm to 1000x600mm. The stand offers a vertical adjustment range of 19.7 inches (500mm) and operates on a voltage of 100-240V with a maximum power consumption of 150W.





The stand can be controlled via a wireless remote or touch control. The overall dimensions include a width of 47.2 inches (1200mm), a height that can extend from 49.2 inches (1250mm) to 69.1 inches (1750mm), and a maximum depth of 36.4 inches (880mm).

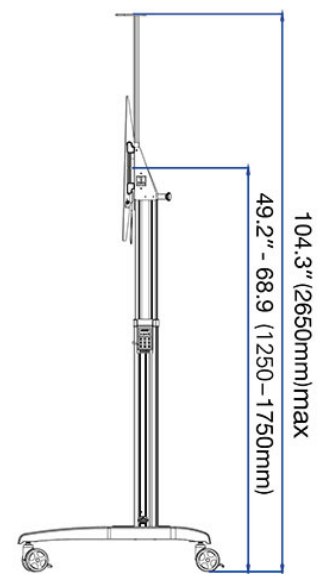
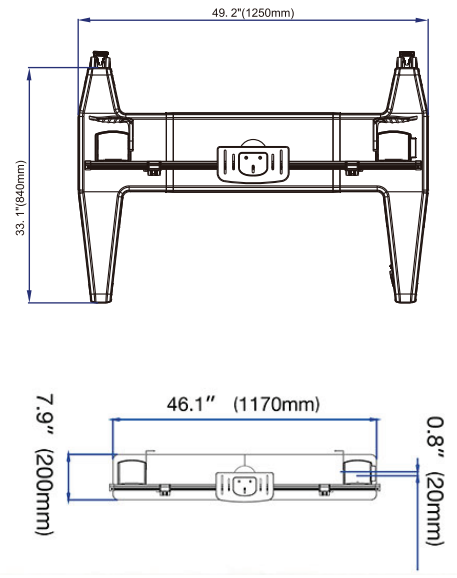
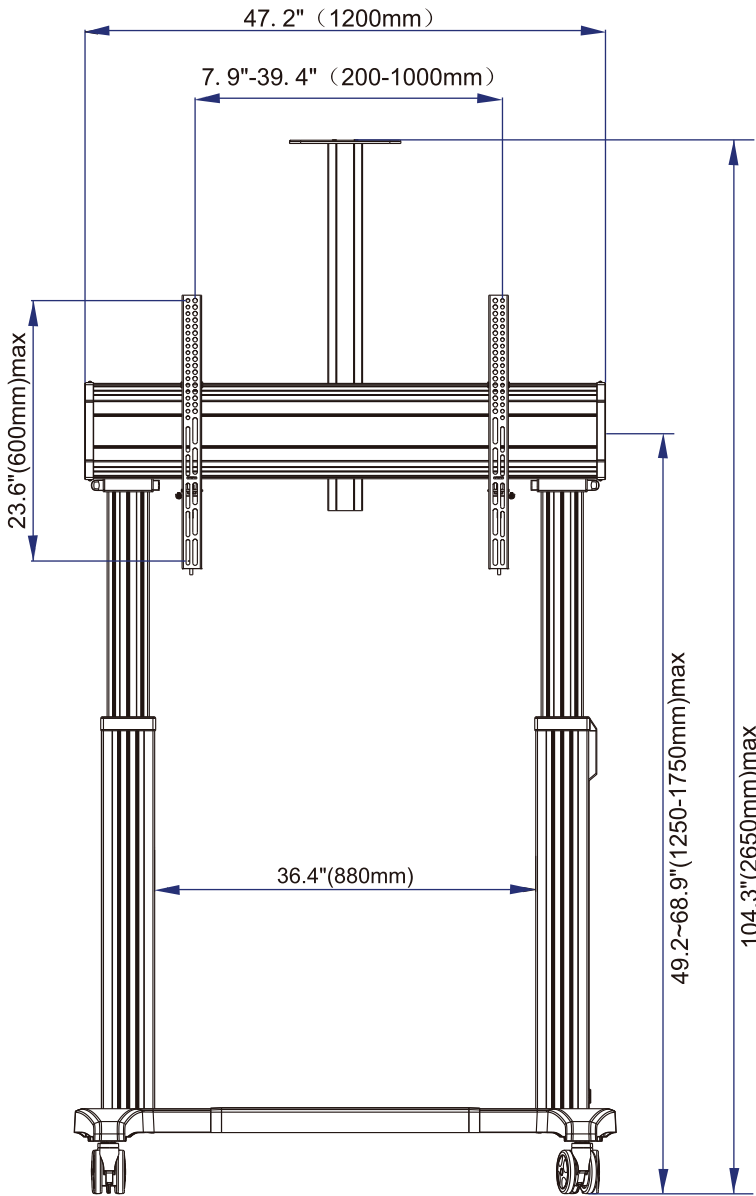

The monitor stand is equipped with durable wheels, allowing for easy mobility and positioning of large screens. This feature makes it convenient to move the stand across different locations without the need for heavy lifting.

TECHNICAL SPECIFICATION



- 
 Screen Size
75"-120"
- 
 Capacity
300lbs(136.4kg)
- 
 VESA
200x200-1000x600mm
- 
 Upright
19.7" (500mm)
- 
 Input voltage
100~240V 50/60HZ
- 
 Rated power
150W Max
- 
 Operation method
wireless remote control
or touch control



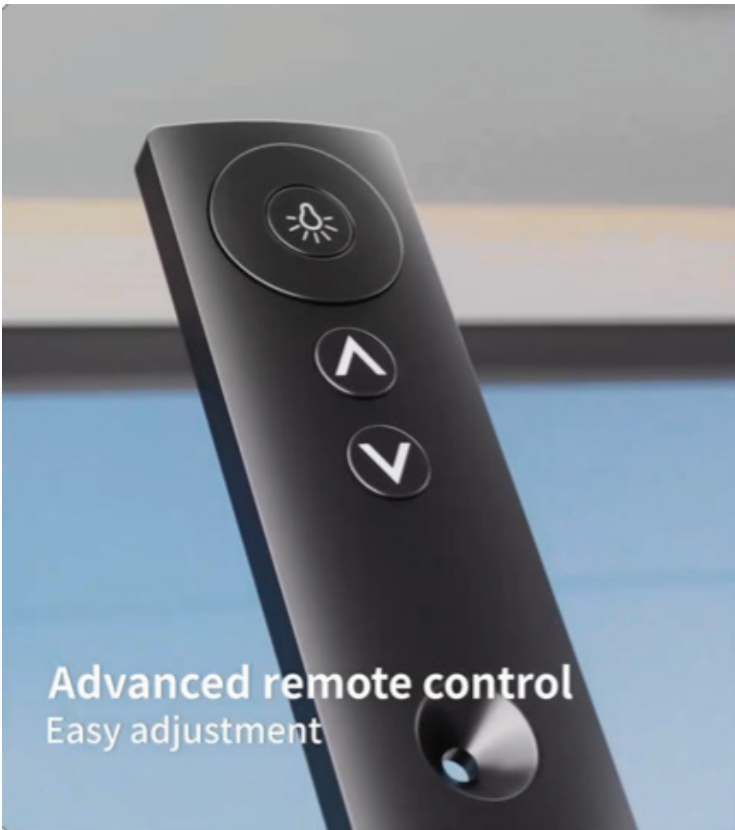

Advanced remote control
Easy adjustment



Child Lock
One click lock
Prevent accidental touching

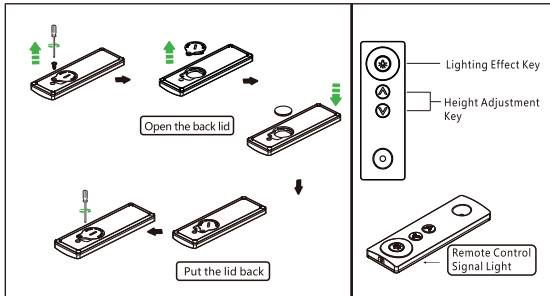

1. How to match remote control with touch control panel
 a. Unplug the power cord.
 b. Press and hold the **[Lighting Effect Key]** button until signal light flashes.
 c. Keep holding and plug the power cord until the signal lights off. Now the remote control matched with touch control panel successfully.

2. Height adjustment
 Press the **[Up Arrow]** button to raise.
 Press the **[Down Arrow]** button to lower.

3. Light adjustment
 Press and hold the **[Lighting Effect Key]** button to switch light on/off.

ATTENTION!

- Lithium battery specification: CR2032.
Attention: according to restrictions on shipping lithium batteries to certain countries and regions, we will NOT be able to put lithium battery in the remote control for certain countries and regions.
- DO NOT disassemble remote control. It can cause control failure.
- DO NOT drop it or expose it to direct sunlight or extreme heat environment. Keep away from liquids.
- Remove the battery when the remote is not in use for extended periods. This will prevent damage from battery leakage.
- If remote control doesn't work, please take the battery out. Reload the battery after 30 seconds. If it cannot work, please replace battery.

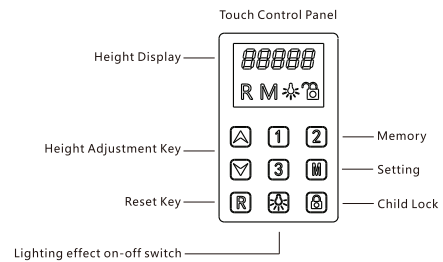

ATTENTION:
 Before TV mounting, RESET must be made in non-loaded condition. Please connect the power(100-240V) and unlock touch control panel. Press and hold **[R]** button until display shows "1250". It indicates the unit is functioning properly. Please refer to Reset Procedure below for specific operation.

Reset Procedure	Press and hold [R] button until "----" flashes, reset procedure is started. The stand reaches its minimum height when display shows "1250". Now the reset is completed.
Memory Setting	Save up to three commonly used heights and recall them quickly. Press [Up] / [Down] button to move the stand to the required height. Press [1] button, [M] lights, and then "S----" flashes. Press [1] / [2] or [3] button to assign the current height to a number, memory setting is done. To restart your memory height, press and hold [1] / [2] or [3] button for two seconds accordingly. The stand will move to the height you preset automatically.
Lighting Effect On-Off Switch Setting	ON: press and hold [Lighting Effect Key] until button lights in red and lighting effect is switched on. OFF: press and hold [Lighting Effect Key] until button lights off and lighting effect is switched off.
Child Lock Setting	TO LOCK: press and hold [L] until button lights in red. TO UNLOCK: press and hold [L] until [L] appears.
To Raise	Press and hold [Up Arrow] button, the stand will raise at a steady speed. Release pressing, height adjustment is done.
To Lower	Press and hold [Down Arrow] button, the stand will lower at steady speed. Release pressing, height adjustment is done.

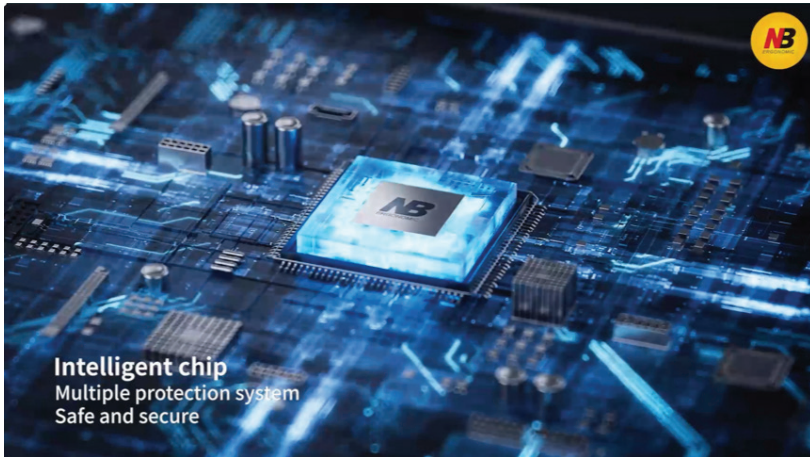
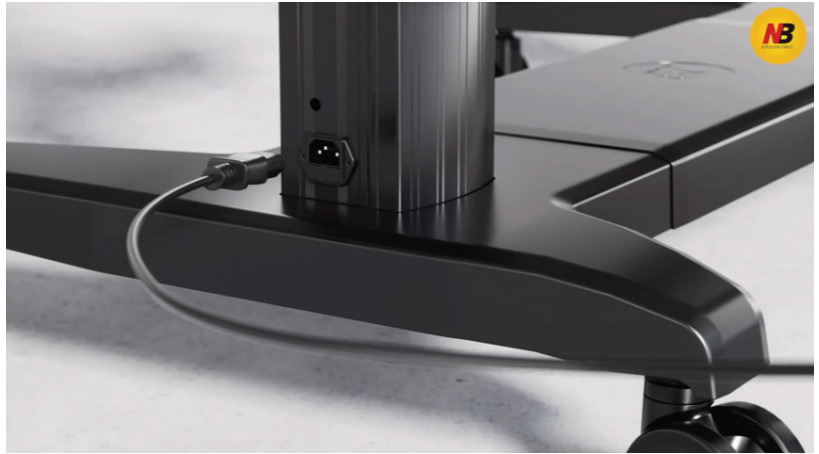
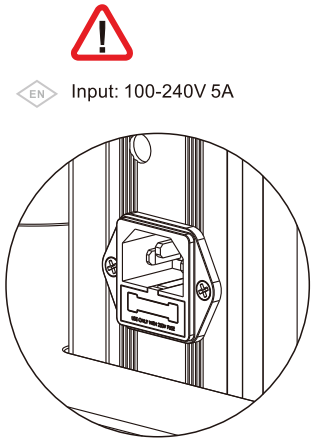

The "NB" motorized floor stand, featuring an "Intelligent chip" with a focus on safety and security. The chip is designed with a multiple protection system, ensuring that the motorized stand operates reliably and securely. This advanced chip likely manages various functions of the stand, such as controlling movements, monitoring performance, and preventing potential issues, contributing to the overall stability and efficiency of the device.

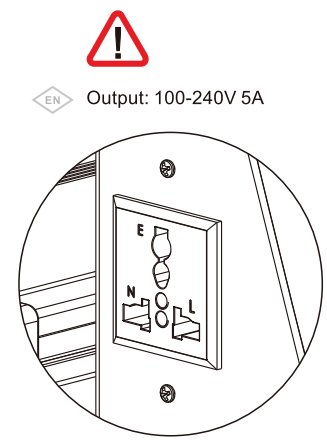

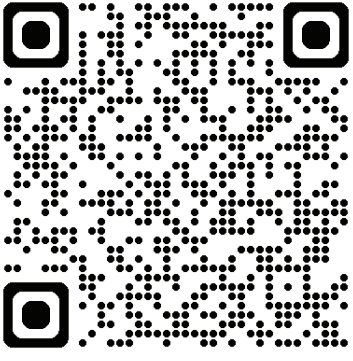

Doing it Right!



Doing it Right!

+971 50 950 9334

+971 4 558 7680

info@techfortme.com

www.techfortme.com

Office 26, Al Suwaidi Sons Building,
Nakheel Road, Deira, Dubai, UAE

تك فورت للتجارة العامة ش م م

TECHFORT